

Multi-monti - Hex Head Range

BRIGHT ZINC PLATE The innovative fastening system for concrete and masonry with building regulation approval

The approved installation system MULTI-MONTI is based on a new application principle in anchoring technology. The screw anchor is driven in without a plug.

Advantage: Huge time savings during installation.

The technical advantages speak for themselves. Low driving torque, connection free of expansion pressure and approval for cracked and uncracked concrete are the key features of this screw anchor.

The MULTI-MONTI anchor gives you a positive locking connection that is free of expansion pressure – in half the time.

MULTI-MONTI lets you work close to edges, no torque wrench is required and the screw anchor can be re-used. You will find application examples of the MULTI-MONTI screw anchor not only in the Reichstag in Berlin or Magdeburg's lake stage, but also in the housing sector, for installing balcony railings or fixing fences.

MULTI-MONTI – the advantages:

- No cure times, instant loading of anchor.
- Through-hole installation is always possible
- No specified installation torque
- Problem-free machine positioning
- Up to 50% reduction in installation times
- MULTI-MONTI can be removed (and reused)
- With building regulation approval (ETA)

For outdoors: MULTI-MONTI in stainless steel PLEASE RING FOR PRICES

For outdoor applications or where anchors are exposed to atmospheric influences, MULTI-MONTI is also available in A4 and A5 stainless steel.

These days, it's also hard to imagine the tunnel building sector without the MULTI-MONTI screw in 1.4529 grade stainless steel. The screw anchor has been used in many projects, including the building of the 4th Elbe tunnel tube in Hamburg or the Herrrentunnel in Lübeck.

Innovation prize for screw anchor

The innovative and patented screw anchor has not just won over HECO customers at home and abroad, it has also impressed the state government of Baden-Wuerttemberg. Minister of Economy, Walter Döring, awarded the MULTI-MONTI screw anchor the state innovation prize.

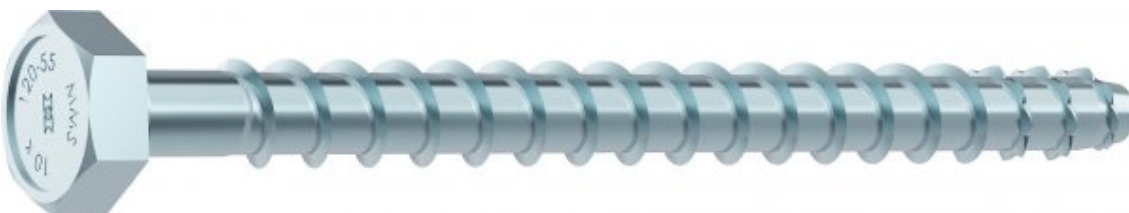

Price

MULTI-MONTI HMS 7,5x35 pr box100 (Product reference 3664-7952)	£19.22
MULTI-MONTI HMS 7,5x40 pr box100 (Product reference 3664-7953)	£20.41
57MULTI-MONTI MMS 7,5x50 pr box100 (Product reference 3664-7954)	£23.98
57MULTI-MONTI MMS 7,5x45 pr box100 (Product reference 3664-7955)	£22.91
MULTI-MONTI MMS-S 7,5x60 pr box100 (Product reference 3664-7960)	£24.28
MULTI-MONTI MMS-S 7,5x80 pr box50 (Product reference 3664-7962)	£19.89
MULTI-MONTI HMS 6x40 pr box 200 (Product reference 3664-7964)	£34.55
MULTI-MONTI MMS 6x50 pr box100 (Product reference 3664-7966)	£18.36
MULTI-MONTI MMS 6x60 pr box100 (Product reference 3664-7967)	£21.57
MULTI-MONTI MMS 6x80 pr box50 (Product reference 3664-7968)	£16.32
MULTI-MONTI MMS 6x100 pr box50 (Product reference 3664-7969)	£17.51
MULTI-MONTI MMS-S 7,5x100 pr box50 (Product reference 3664-7970)	£21.53
MULTI-MONTI MMS-S 7,5x120 pr box50 (Product reference 3664-8007)	£23.15
MULTI-MONTI MMS-S 7,5x140 pr box50 (Product reference 3664-8008)	£23.74